

SITE DESCRIPTION

31-48-43 S 180° OF W 1/4 OF SW 1/4 OF SE 1/4 LYING E  
OF CANAL R/W 4 LESS E 25 4 S 50 FOR CO  
RDS LESS BEG AT INTERSECTION OF W/R/W/L OF  
N RIVERSIDE DR WITH N/R/W/L OF ATLANTIC  
BLVD., W319.84, NE 5.10, E 288.81, NE 35.34, N  
100.03, E5, S130 TO FOB

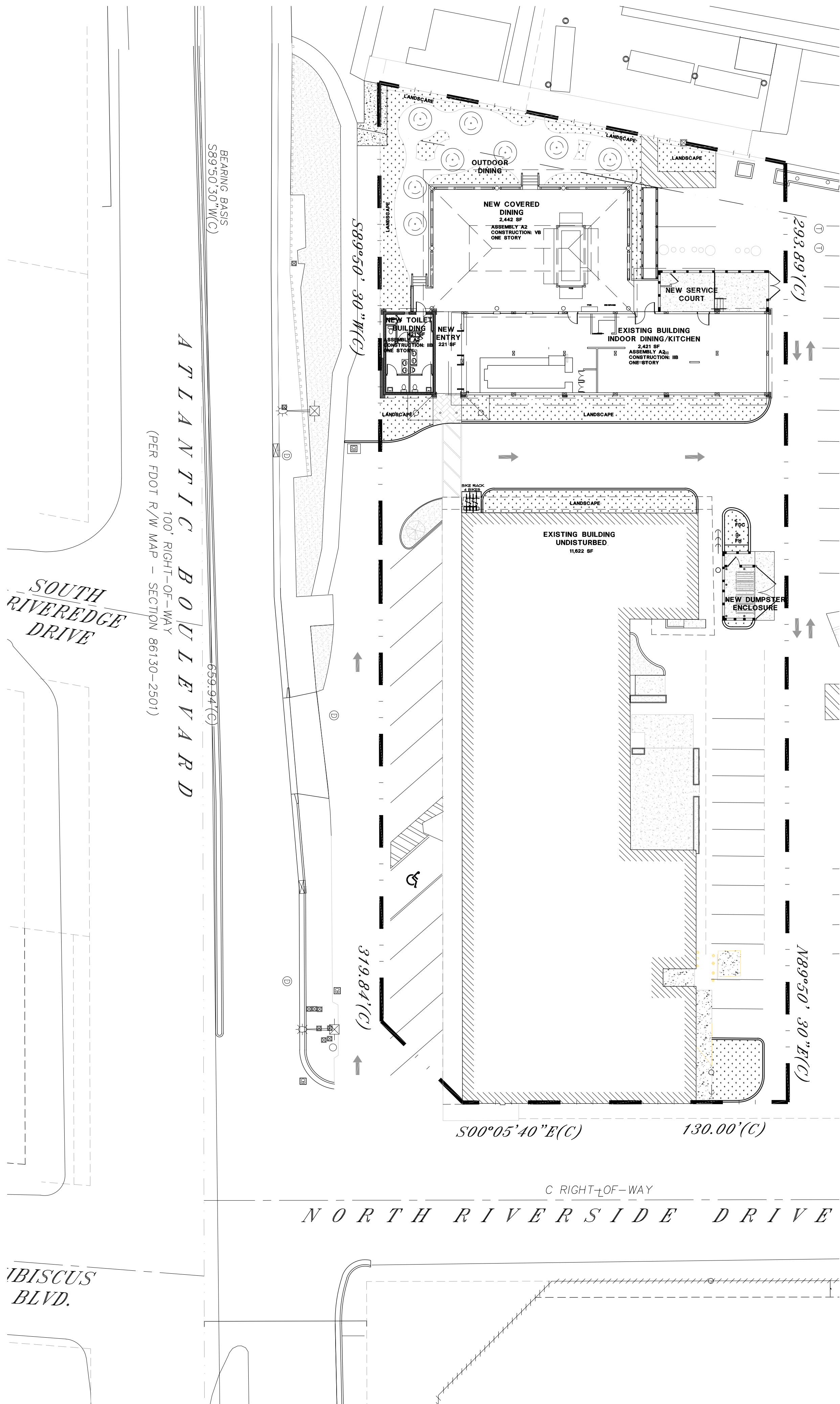

01 SITE PLAN - ENTIRE SITE  
SCALE: 1" = 20'

ALL IDEAS, DESIGNS, ARRANGEMENTS AND PLANS INDICATED  
OR REFERENCED BY THIS PLAN AND NEW OR EXISTING  
CONSTRUCTION SHALL BE IN ACCORDANCE WITH THE  
LATEST EDITIONS OF THE FLORIDA BUILDING CODE AND  
ALL OTHER APPLICABLE CODES. THE DESIGNER SHALL  
VERIFY THE ACCURACY OF ALL INFORMATION PROVIDED  
BY THE CLIENT AND THE DESIGNER SHALL BE RESPONSIBLE  
FOR OBTAINING ALL NECESSARY PERMITS AND APPROVALS  
FROM THE APPROPRIATE AGENCIES. THE DESIGNER SHALL  
PROCEED WITH PUBLICATION ON ITEMS SO NOTED.

PH: (954) 941-3329 FAX: (954) 943-1108  
**design kollaborative**  
architects / planners, inc.  
MEMBER: AMERICAN INSTITUTE OF ARCHITECTS - AA 000954  
61 NE 1ST STREET, SUITE 2, POMPANO BEACH, FL 33060

Blaise E.  
McGinley  
2021.04.01 11:44  
30-04'00"  
Blaise McGinley  
ARCHITECT ASSOCIAT

NEW RESTAURANT  
**TAHA MARINE CENTER**  
3109-3231 E ATLANTIC BLVD  
POMPANO BEACH, FL 33062

DATE		
04/09/2020		
PERMIT 00/00/00		
CONSTR. 00/00/00		
PROJECT NO.		
20006		
BY	REVISIONS	DATE

SHEET NO.  
**SP100**  
PRINTED: 4/1/2021 11:04 AM